

# Smooove® 1 RTS Pure

Item #: 1811533



## OVERVIEW:

The **Smooove® 1 RTS** is a single-channel wall switch to control Radio Technology Somfy® (RTS) motorized window coverings. The switch is surface-mounted and battery-powered. Additional frames are available in multiple colors and finishes (sold separately).



## TECHNICAL SPECIFICATIONS:

- Input: 3V; 290mAh
- Power Consumption: CR2430 Battery
- Material: ABS
- Protection Rating: IP 30
- For interior use only
- Dimensions: 3.15" x 3.15" x .39" (with frame) & 1.97" x 1.97" x .39" (without frame)
- Maximum Range: Up to 65 feet under optimum conditions
- Operating Temperature Range: 32°F to 140°F (0°C / + 60°C)
- Frequency: 433.42Mhz
- Shipping Weight: 1 lb.
- CE Rated
- FCC Certified

## FEATURES SUMMARY:

- Battery-operated
- Surface-mounted
- Single channel control for one window covering or one group of window coverings
- 7 decorative frames available
- Tactile buttons for up/down/my/stop control
- LED illuminates to confirm RTS signal transmission

## WHAT'S IN THE BOX:

- Smooove 1 RTS Pure
- CR2430 battery
- Pure frame
- Mounting plate
- Instructions

## OPTIONAL ACCESSORIES:

- Smooove Frame, Black #9015023
- Smooove Frame, Silver Matte #9015025
- Smooove Frame, Light Bamboo #9015027
- Smooove Frame, Walnut #9015237
- Smooove Frame, Cherry #9015236
- Smooove Frame, Amber Bamboo #9015026
- Smooove Double Frame, Pure #9015238
- Smooove Frame, Pure #9015022
- Replacement Battery for Transmitters 3V CR2430 #9012091

## CONNECTIONS AND INDICATORS:

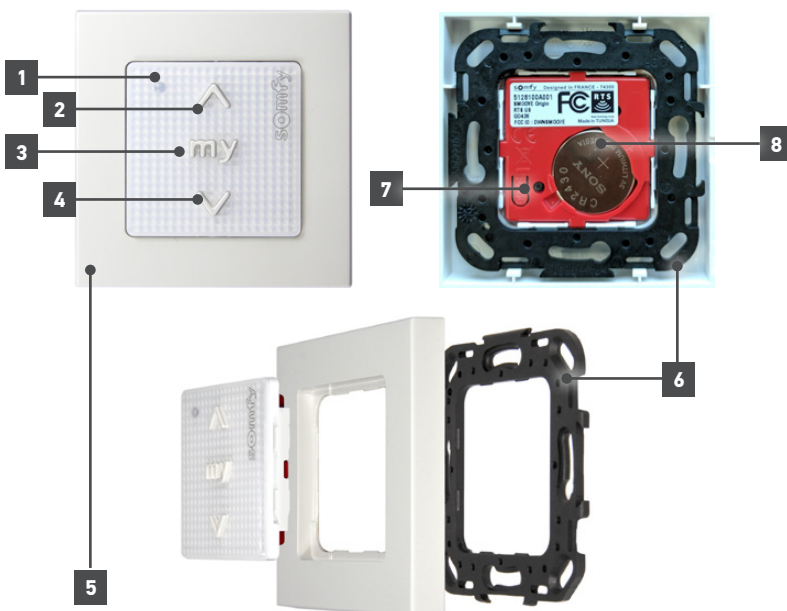

ELEMENT	FUNCTION
1 <b>LED Indicator</b>	Illuminates to confirm RTS signal transmission
2 <b>UP Button</b>	Up directional button
3 <b>"MY" Button</b>	"MY" favorite position or STOP button
4 <b>DOWN Button</b>	Down directional button
5 <b>Interchangeable Frame</b>	Available in 7 colors
6 <b>Mounting Plate</b>	Allows for surface mount
7 <b>Programming Button</b>	Used for RTS programming
8 <b>Third-party Battery</b>	Uses CR2430 battery

DIMENSIONS:

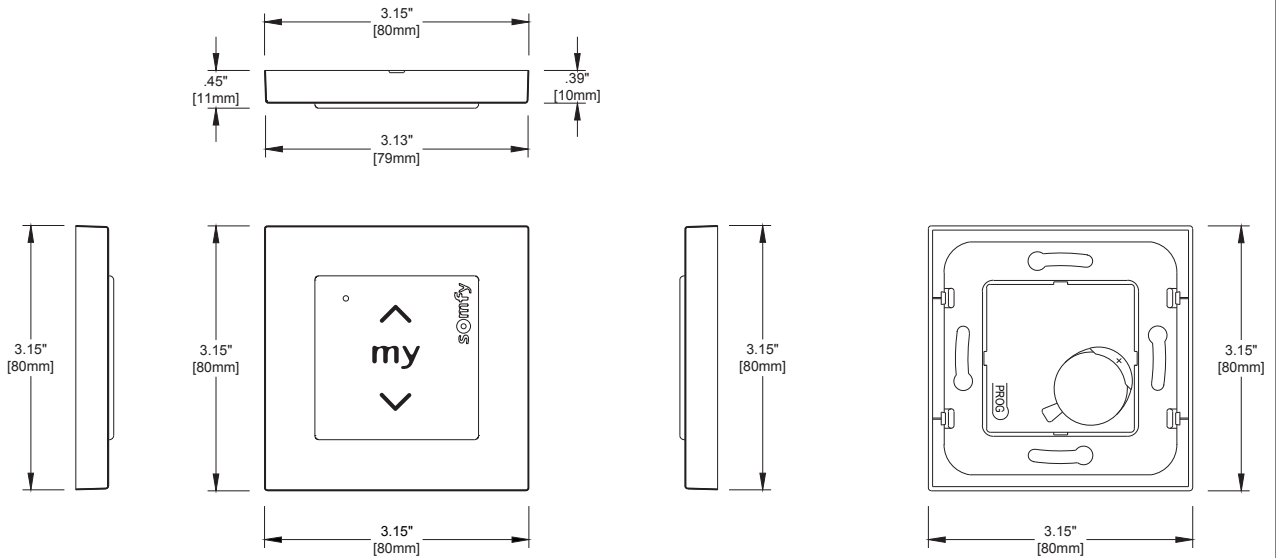

BEST WIRING PRACTICES

The diagram shown below is meant for illustrative purposes to show the connections from product to product. This device could be used in other configurations than shown below. For specification information on individual products, see related product information.

